

CITY OF
BAYARD Nebraska



ONE (1) & SIX (6) YEAR
STREET IMPROVEMENT PROGRAM

2025
2025 - 20230

Prepared by; Jeff Wolfe (S-1025)
M.C. Schaff & Associates
818 South Beltline Hwy E.
Scottsbluff, NE 69361

GENERAL

Due to financial limitations the City of Bayard did not complete project M-137(52) during the 2024 calendar year. The City of Bayard did perform normal maintenance on the city streets during the 2024 calendar year.

The City plans to complete project M-137(52) and perform normal maintenance during the 2025 calendar year.

ONE YEAR PLAN

M-137(52) - Remove and replace pavement, curb, and gutter on 2nd Avenue from 4th Street to 5th Street (\$350,000).

SIX YEAR PLAN

M-137(36c) - Construct asphalt overlay on 1st Avenue from 5th Street to 6th Street (\$100,000).

M-137(51) - Seal Coat Ave A from 10th St. to 11th St (\$30,000).

M-137(7) - Construct intersections at Avenue B and 3rd Street, and Avenue B and 4th Street (\$160,000).

M-137(9) - Construct curb and gutter on Avenue A from 2nd Street to 4th Street and on Avenue B, from 3rd Street to 5th Street (\$200,000).

M-137(22) - Construct curb, gutter and pavement on 3rd Street from Avenue A to Avenue B (\$350,000).

M-137(48) - Construct curb, gutter and pavement on 13th Street from Main Street to Avenue C (\$350,000).

M-137(49) - Construct curb, gutter and pavement on 14th Street from Main Street to Avenue C (\$350,000).

M-137(50) - Construct ADA access intersections Citywide (\$75,000).

M-137(53) - Reconstruct 8th Street from Main to 1st Avenue (\$350,000).

M-137(54) - Reconstruct intersection at 6th Street and 1st Avenue (\$300,000).

M-137(55) - Reconstruct 5th Street from Avenue A to Avenue B (\$350,000).

M-137(56) - Reconstruct Avenue B from 5th Street to 6th Street
(\$350,000).

RESOLUTION 1046

TO WHOM IT MAY CONCERN:

At the regular meeting of the City Council of the City of Bayard, Nebraska, held in the City Hall on November 12, 2024, a hearing was held on the One (1) and Six (6) Year Street Improvement Program at 7:00 P.M., as advertised. Following a discussion by the City Council and citizens present, a motion was made to adopt the One (1) and Six (6) Year Street Improvement Program for the calendar year 2025. Roll call vote brought: "Yeas", 5; "Nays", 0. Motion carried.

CERTIFICATION

I, the undersigned, duly qualified and acting Clerk of the City of Bayard, Nebraska, do hereby certify that the above is a true and certified copy of action passed on November 12, 2024, and I officially affix my signature and the seal of said City on this 12th day of November, 2024.

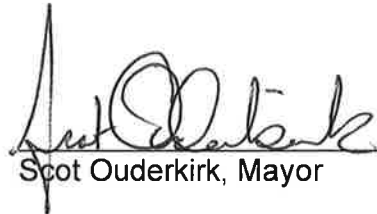

Scot Ouderkirk, Mayor



Shelly Bowlin - City Clerk

Affidavit of Publication

State of Nebraska

SS

County of Morrill

KC Heath being first duly sworn, deposes and says that he is the Editor of Bayard Transcript, a legal newspaper, published at Bayard, Morrill County, Nebraska and of general circulation in said County and State, and that a notice copy of which hereby attached:

City of Bayard 1 & 6 yr Plan

was published in issue of every number of the paper (not a supplement) during the pe-riod of publication, for 7 consecutive week(s), the first insertion having been made October 30, 2024 and the last insertion on _____, 20____.

Number of lines/inches: 27

Publisher's Fees: 10.13

KC Heath

(Signature)

Roberta A Rummel

(Notary Signature)

Subscribed in my presence and sworn to before me this:

November 25, 2024

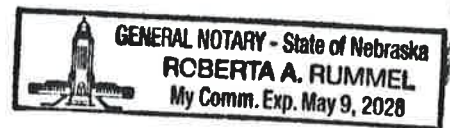

HELP WANTED

HELP WANTED

Looking for a great place to work? We are looking for a dynamic individual to join our team. Morrill County Community Hospital has exciting new opportunities. We are accepting applications for:

- Clinic Nurse (MA, LPN, RN)
- Daycare Staff
- EMT / Paramedic
- Home Health Nurse (RN)
- Housekeeping for Bayard Clinic
- Infection Control Coordinator
- Medical Lab Assistant
- Registered Nurse for hospital setting (day & night shift)
- Specialty Clinic Nurse (LPN, RN)

Interested applicants may send resume to basar@morrillcountyhospital.org or visit www.morrillcountyhospital.com for more details. Morrill County Community Hospital is an EEO Employer.

NOTICE OF MEETING

Notice is hereby given that the Morrill County Veteran's Service Board will meet in an open and public meeting on Friday, November 1st, 2024 at 9:00 A.M in the Commissioner Meeting Room at the Courthouse.

Chairman of the Board- Ismael "Milo" Cardenas
 Veteran Service Officer - Tim Marquez

**NOTICE OF MEETING
Board of Education**

Notice is hereby given that a Board of Education Retreat/Work Session of the School District of Bayard in the Counties of Morrill, Scotts Bluff, Box Butte, and Banner in the State of Nebraska will be held on Thursday, Novem-

LEGAL NOTICE

ber 7, 2024 at 5:00 PM in the Bayard High School Library located at 726 4th Avenue, Bayard, NE 69334, which meeting shall be open to the public. An agenda for such meeting, kept continuously current is available for public inspection during normal business hours at the office of the Superintendent, located at 726 4th Avenue, Bayard, NE 69334. Retreat/Work Session.

NOTICE OF PUBLIC HEARING

A public hearing on the One (1) and Six (6) year Street Improvement Program for the City of Bayard, Nebraska, will be held in the City Office Meeting Room at 7:00 P.M., November 12, 2024. The purpose of the hearing is to propose to the residents of the City, One (1) Year Definite Street Improvement and Six (6) Year Tentative Street Improvement Program in compliance with Section 39-2115 and 39-2119 of Chapter 39 of the Cumulative Supplement of the Revised Statutes of Nebraska, 1943. Copies of the proposed One (1) and Six (6) Year Street Improvement Programs may be studied in the office of the City Clerk.

Shelly Bowlin,
 Bayard City Clerk
 27

**HEARING NOTICE
MORRILL COUNTY
BOARD OF COMMISSIONERS**

Notice is hereby given that the Morrill County Board of Commissioners will conduct a public hearing on Tuesday, November 12, 2024, at 8:30 am in the Commissioner's Room at the Morrill County Courthouse. The purpose of this hearing

LEGAL NOTICE

is to hear public comment proposed sale of several properties owned by Morrill County. The purpose of the public hearing is to allow any interested party to speak for or against the sale or the properties or raise any issue regarding fair market value of the property as determined by the Court Board. The properties be considered for sale are:

1. Lot 8, Block 7, 2 nd San McCaffree Addition to City of Bayard, Morrill County, Nebraska.
2. Lot 12, Block 8, 2 nd San McCaffree Addition to City of Bayard, Morrill County, Nebraska.
3. Lot 11, Block 8, 2 nd San McCaffree Addition to City of Bayard, Morrill County, Nebraska.
4. Lot 10, Block 8, 2 nd San McCaffree Addition to City of Bayard, Morrill County, Nebraska.
5. Lot 9, Block 8, 2 nd San McCaffree Addition to City of Bayard, Morrill County, Nebraska.

/s/ Jeff Metz, Chairperson
 Board of Commissioners

**HEARING NOTICE
MORRILL COUNTY
BOARD OF COMMISSIONERS**

Notice is hereby given that the Morrill County Board of Commissioners will conduct a public hearing on Tuesday, November 12, 2024, at 8:00 am in the Commissioner's room at the Morrill County Courthouse. The purpose of this hearing is to hear public comment on a proposed conservation easement between Red Dog Ranch, LLC and Wetland America Trust Inc. The prop

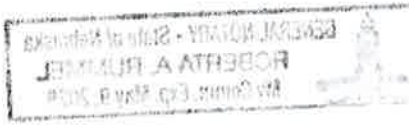

STATE-WIDE CLASSIFIEDS

**ANNOUNCEMENT
CLASSIFIED ADVERTIS-**

DENTAL INSURANCE
 from Physicians Mutual In-

5-Year warranty with qualify-
 ing purchase. Call 1-402-899-

November 12, 2024

State of Nebraska
Department of Roads
Board of Classifications & Standards
P.O. Box 94759
Lincoln, NE 68509-4759

RE: One (1) & Six (6) Year Street Improvement Program
Bayard, Nebraska (M-137)

CERTIFICATION

I, Jeff Wolfe, the Street Superintendent for the City of Bayard, Nebraska, do hereby certify that I posted the "Notice for Public Hearing" for the Proposed One (1) and Six (6) Year 2025 Street Improvement Program in three (3) public places within the City limits of Bayard, Nebraska:

Bayard City Office
445 Main Street

Bayard Post Office
517 Main Street

FNBO
302 Main Street

DATED this 12th day of November, 2024.

Signed: Jeff Wolfe
Jeff Wolfe
Street Superintendent #1025

NOTICE OF PUBLIC HEARING

A public hearing on the One (1) and Six (6) year Street Improvement Program for the City of Bayard, Nebraska, will be held in the City Office Meeting Room at 7:00 P.M., November 12, 2024. The purpose of the hearing is to propose to the residents of the City, One (1) Year Definite Street Improvement and Six (6) Year Tentative Street Improvement Program in compliance with Section 39-2115 and 39-2119 of Chapter 39 of the Cumulative Supplement of the Revised Statutes of Nebraska, 1943.

Copies of the proposed One (1) and Six (6) Year Street Improvement Programs may be studied in the office of the City Clerk.

Shelly Bowlin -Bayard City Clerk

Published October 30, 2024

STATEMENT OF CHANGES

I, Jeff Wolfe, the Street Superintendent for the City of Bayard, Nebraska, do hereby state that the original plans for the Proposed 2025 One (1) and Six (6) Year Road Improvement Program for the City of Bayard, Nebraska was presented to the Bayard Council on November 12, 2024 and no changes were made to the plan as proposed and presented herein.

DATED THIS 12th DAY OF NOVEMBER, 2024.

Signed: Jeff Wolfe
Jeff Wolfe,
Street Superintendent (S-1025)

One- And Six-Year Plan Highway, Road or Street Improvement Work/Project

GENERAL INFO	Name (County or Municipality): Bayard <input checked="" type="checkbox"/> Existing W/P <input type="checkbox"/> New W/P <input type="checkbox"/> Revision W/P						
	Work/Project (W/P) Number: M-137 (7)		Work/Project Length: 200.00		feet		
	Other Work/Project Number:				Control Number:		
	Interlocal Agreement: <input type="checkbox"/> Yes <input checked="" type="checkbox"/> No If Yes, Name of Other Entity:						
REVISIONS	Location Intersection of Avenue B and 3rd Street. Intersection of Avenue B and 4th Street. Install new						
	Description: PCC pavement, curb, gutter, and walks.						
STDS	If Revision, describe the changes:						
	Notification of Revision of One-Year Plan? <input type="checkbox"/> Yes <input type="checkbox"/> No If Yes, what is the reason? <input type="checkbox"/> Revisions to the Work/Project <input type="checkbox"/> Emergency Work/Proj Needed <input type="checkbox"/> Additional Funding Available <input type="checkbox"/> Other: _____						
TRAFFIC	Functional Class National: Local State: Local						
	Design Standards Table 2-001. 03. F		National Highway System: <input type="checkbox"/> Yes <input checked="" type="checkbox"/> No				
ROADWAY	Design Speed: 25 MPH		Posted/Anticipated Speed = 25 MPH				
	Avg Daily Traffic :	Initial Year 2018	VPD 100	Hvy Trucks % 5	Design Year 2050	VPD 200	Hvy Trucks % 5
BRIDGES & STRUCTURES	HIGHWAY, ROAD OR STREET		EXISTING		PROPOSED IMPROVEMENT		
	Traveled Way:	Surface Type Gravel	Width (ft) Varies	Surface Type Concrete	Thickness (in) 6	Width (ft) Varies	Work Type N&R
	Shoulders:	Earth	Varies	Concrete	6	Varies	
OTHER SCOPE	BRIDGES AND STRUCTURES		EXISTING		PROPOSED IMPROVEMENT		
	Structure Number(s) City/County - NBIS		Structure Type	Condition SR SD FO	Structure Type	Size	Design Loading and Work Type
				____ <input type="checkbox"/> <input type="checkbox"/>			
				____ <input type="checkbox"/> <input type="checkbox"/>			
ANALYSES	Other Scope of Work:			<input checked="" type="checkbox"/> Grading <input type="checkbox"/> Acquire Right of Way <input type="checkbox"/> Remove Existing Bridge/Structure <input type="checkbox"/> Add Auxiliary Lane(s) <input type="checkbox"/> Guardrail <input type="checkbox"/> Other Utilities Work <input type="checkbox"/> Bridge Re-deck <input type="checkbox"/> Sidewalk/Trail <input type="checkbox"/> Fencing <input type="checkbox"/> Lighting <input type="checkbox"/> Bridge Rail <input type="checkbox"/> Removal of Roadside Obstacles <input checked="" type="checkbox"/> Curb Work <input type="checkbox"/> Traffic Control Devices <input type="checkbox"/> Storm Sewer or Culverts <input type="checkbox"/> Flatten Vertical Curve(s) <input checked="" type="checkbox"/> Curb Ramp(s) <input type="checkbox"/> Construction Detour <input type="checkbox"/> Erosion Control <input type="checkbox"/> Other: _____			
	Drainage Study Completed for Structures/Drainage Facilities <input type="checkbox"/> Yes <input type="checkbox"/> Pending <input checked="" type="checkbox"/> N/A			Work/Project Relaxation of Standards Requested <input type="checkbox"/> Yes <input type="checkbox"/> Pending <input checked="" type="checkbox"/> N/A			
FINANCIAL	Analyses Completed: <input type="checkbox"/> Yes <input type="checkbox"/> Pending <input checked="" type="checkbox"/> N/A			Cost Effective Analysis <input type="checkbox"/> Yes <input type="checkbox"/> Pending <input checked="" type="checkbox"/> N/A			
	Other Benefit/Cost Analysis <input type="checkbox"/> Yes <input type="checkbox"/> Pending <input checked="" type="checkbox"/> N/A						
Nebraska licensed engineer providing design and construction phases services: <input checked="" type="checkbox"/> Yes <input type="checkbox"/> No							
Construction Period (estimated): 60.0 working days							
Other Funds to be Applied: <input type="checkbox"/> Federal Fund Purchase Program <input type="checkbox"/> State-Aid Bridge Fund <input type="checkbox"/> Federal Funds thru NDOR <input type="checkbox"/> LB960 County Bridge Match Program <input type="checkbox"/> State Recreation Road Fund <input type="checkbox"/> Other: _____							
Estimated Costs (1,000)		County	Municipality	State	Federal	Other	Total
			160				160
Print Name: Jeff Wolfe			Title: City Street Superintendent		Date: 11/12/2024		
Signature: 							

One- And Six-Year Plan Highway, Road or Street Improvement Work/Project

GENERAL INFO	Name (County or Municipality): Bayard <input checked="" type="checkbox"/> Existing W/P <input type="checkbox"/> New W/P <input type="checkbox"/> Revision W/P						
	Work/Project (W/P) Number: M-137 (9)		Work/Project Length: 0.50		miles		
	Other Work/Project Number:				Control Number:		
	Interlocal Agreement: <input type="checkbox"/> Yes <input checked="" type="checkbox"/> No If Yes, Name of Other Entity:						
REVISIONS	Location Avenue A from 2nd Street to 4th Street. Avenue B from 3rd Street to 5th Street. Install new						
	Description: curb, gutter, and grading						
STDS	If Revision, describe the changes:						
	Notification of Revision of One-Year Plan? <input type="checkbox"/> Yes <input type="checkbox"/> No If Yes, what is the reason? <input type="checkbox"/> Revisions to the Work/Project <input type="checkbox"/> Emergency Work/Proj Needed <input type="checkbox"/> Additional Funding Available <input type="checkbox"/> Other: _____						
TRAFFIC	Functional Class National: Local		State: Local				
	Design Standards Table 2-001. 03. F		National Highway System: <input type="checkbox"/> Yes <input checked="" type="checkbox"/> No				
ROADWAY	Design Speed: 25 MPH		Posted/Anticipated Speed = 25 MPH				
	Avg Daily Traffic :	Initial Year 2018	VPD 200	Hvy Trucks % 5	Design Year 2050	VPD 400	Hvy Trucks % 5
BRIDGES & STRUCTURES	HIGHWAY, ROAD OR STREET		EXISTING		PROPOSED IMPROVEMENT		
	Traveled Way:	Surface Type Gravel	Width (ft) Varies	Surface Type Gravel	Thickness (in) 6	Width (ft) Varies	Work Type N&R
	Shoulders:	Earth	Varies	Concrete	6	Curbed	
OTHER SCOPE	BRIDGES AND STRUCTURES		EXISTING		PROPOSED IMPROVEMENT		
	Structure Number(s) City/County - NBIS		Structure Type	Condition SR SD FO	Structure Type	Size	Design Loading and Work Type
				____ <input type="checkbox"/> <input type="checkbox"/>			
				____ <input type="checkbox"/> <input type="checkbox"/>			
ANALYSES	Other Scope of Work:			<input checked="" type="checkbox"/> Grading <input type="checkbox"/> Acquire Right of Way <input type="checkbox"/> Remove Existing Bridge/Structure <input type="checkbox"/> Add Auxiliary Lane(s) <input type="checkbox"/> Guardrail <input type="checkbox"/> Other Utilities Work <input type="checkbox"/> Bridge Re-deck <input type="checkbox"/> Sidewalk/Trail <input type="checkbox"/> Fencing <input type="checkbox"/> Lighting <input type="checkbox"/> Bridge Rail <input type="checkbox"/> Removal of Roadside Obstacles <input checked="" type="checkbox"/> Curb Work <input type="checkbox"/> Traffic Control Devices <input type="checkbox"/> Storm Sewer or Culverts <input type="checkbox"/> Flatten Vertical Curve(s) <input checked="" type="checkbox"/> Curb Ramp(s) <input type="checkbox"/> Construction Detour <input type="checkbox"/> Erosion Control <input type="checkbox"/> Other: _____			
	Drainage Study Completed for Structures/Drainage Facilities <input type="checkbox"/> Yes <input type="checkbox"/> Pending <input checked="" type="checkbox"/> N/A			Work/Project Relaxation of Standards Requested <input type="checkbox"/> Yes <input type="checkbox"/> Pending <input checked="" type="checkbox"/> N/A			
FINANCIAL	Analyses Completed: <input type="checkbox"/> Yes <input type="checkbox"/> Pending <input checked="" type="checkbox"/> N/A			Cost Effective Analysis <input type="checkbox"/> Yes <input type="checkbox"/> Pending <input checked="" type="checkbox"/> N/A			
	Other Benefit/Cost Analysis <input type="checkbox"/> Yes <input type="checkbox"/> Pending <input checked="" type="checkbox"/> N/A						
Nebraska licensed engineer providing design and construction phases services: <input checked="" type="checkbox"/> Yes <input type="checkbox"/> No							
Construction Period (estimated): 60.0 working days							
Other Funds to be Applied: <input type="checkbox"/> Federal Fund Purchase Program <input type="checkbox"/> State-Aid Bridge Fund <input type="checkbox"/> Federal Funds thru NDOR <input type="checkbox"/> LB960 County Bridge Match Program <input type="checkbox"/> State Recreation Road Fund <input type="checkbox"/> Other: _____							
Estimated Costs (1,000)		County	Municipality	State	Federal	Other	Total
			200				200
Print Name: Jeff Wolfe			Title: City Street Superintendent		Date: 11/12/2024		
Signature: 							

One- And Six-Year Plan Highway, Road or Street Improvement Work/Project

GENERAL INFO	Name (County or Municipality): Bayard <input checked="" type="checkbox"/> Existing W/P <input type="checkbox"/> New W/P <input type="checkbox"/> Revision W/P																	
	Work/Project (W/P) Number: M-137 (22)		Work/Project Length: 300.00		feet													
	Other Work/Project Number:				Control Number:													
	Interlocal Agreement: <input type="checkbox"/> Yes <input checked="" type="checkbox"/> No If Yes, Name of Other Entity:																	
REVISIONS	Location																	
	Description: 3rd Street from Avenue A to Avenue B. Install new PCC pavement, curb, and gutter.																	
STDS	If Revision, describe the changes:																	
	Notification of Revision of One-Year Plan? <input type="checkbox"/> Yes <input type="checkbox"/> No If Yes, what is the reason? <input type="checkbox"/> Revisions to the Work/Project <input type="checkbox"/> Emergency Work/Proj Needed <input type="checkbox"/> Additional Funding Available <input type="checkbox"/> Other: _____																	
TRAFFIC	Functional Class National: Local State: Local																	
	Design Standards Table 2-001. 03. F National Highway System: <input type="checkbox"/> Yes <input checked="" type="checkbox"/> No																	
ROADWAY	Design Speed: 25 MPH Posted/Anticipated Speed = 25 MPH																	
	Avg Daily Traffic : <table border="1" style="display: inline-table; border-collapse: collapse;"><tr><td>Initial Year</td><td>VPD</td><td>Hvy Trucks %</td><td>Design Year</td><td>VPD</td><td>Hvy Trucks %</td></tr><tr><td>2018</td><td>100</td><td>5</td><td>2050</td><td>200</td><td>5</td></tr></table>							Initial Year	VPD	Hvy Trucks %	Design Year	VPD	Hvy Trucks %	2018	100	5	2050	200
Initial Year	VPD	Hvy Trucks %	Design Year	VPD	Hvy Trucks %													
2018	100	5	2050	200	5													
BRIDGES & STRUCTURES	HIGHWAY, ROAD OR STREET		EXISTING		PROPOSED IMPROVEMENT													
			Surface Type	Width (ft)	Surface Type	Thickness (in)	Width (ft)	Work Type										
ANALYSES	Traveled Way:		Gravel	35	Concrete	6	35	N&R										
	Shoulders:		Earth	4	Concrete	6	Curbed											
OTHER SCOPE	BRIDGES AND STRUCTURES		EXISTING		PROPOSED IMPROVEMENT													
	Structure Number(s) City/County - NBIS		Structure Type	Condition SR SD FO	Structure Type	Size	Design Loading and Work Type											
FINANCIAL	Other Scope of Work:		<input checked="" type="checkbox"/> Grading	<input type="checkbox"/> Acquire Right of Way	<input type="checkbox"/> Remove Existing Bridge/Structure													
	<input type="checkbox"/> Add Auxiliary Lane(s)		<input type="checkbox"/> Guardrail	<input type="checkbox"/> Other Utilities Work	<input type="checkbox"/> Bridge Re-deck													
FINANCIAL	<input type="checkbox"/> Sidewalk/Trail		<input type="checkbox"/> Fencing	<input type="checkbox"/> Lighting	<input type="checkbox"/> Bridge Rail													
	<input type="checkbox"/> Removal of Roadside Obstacles		<input checked="" type="checkbox"/> Curb Work	<input type="checkbox"/> Traffic Control Devices	<input type="checkbox"/> Storm Sewer or Culverts													
FINANCIAL	<input type="checkbox"/> Flatten Vertical Curve(s)		<input checked="" type="checkbox"/> Curb Ramp(s)	<input type="checkbox"/> Construction Detour	<input type="checkbox"/> Erosion Control													
	<input type="checkbox"/> Other: _____																	
FINANCIAL	Drainage Study Completed for Structures/Drainage Facilities <input type="checkbox"/> Yes <input type="checkbox"/> Pending <input checked="" type="checkbox"/> N/A				Work/Project Relaxation of Standards Requested <input type="checkbox"/> Yes <input type="checkbox"/> Pending <input checked="" type="checkbox"/> N/A													
	Analyses Completed: <input type="checkbox"/> Yes <input type="checkbox"/> Pending <input checked="" type="checkbox"/> N/A				Other Benefit/Cost Analysis <input type="checkbox"/> Yes <input type="checkbox"/> Pending <input checked="" type="checkbox"/> N/A													
FINANCIAL	Nebraska licensed engineer providing design and construction phases services: <input checked="" type="checkbox"/> Yes <input type="checkbox"/> No																	
	Construction Period (estimated): 60.0 working days																	
FINANCIAL	Other Funds to be Applied:		<input type="checkbox"/> Federal Fund Purchase Program	<input type="checkbox"/> State-Aid Bridge Fund	<input type="checkbox"/> Federal Funds thru NDOR													
	<input type="checkbox"/> LB960 County Bridge Match Program		<input type="checkbox"/> State Recreation Road Fund	<input type="checkbox"/> Other: _____														
FINANCIAL	Estimated Costs (1,000)		County	Municipality	State	Federal	Other	Total										
				350					350									
FINANCIAL	Print Name: Jeff Wolfe		Title: City Street Superintendent		Date: 11/12/2024													
	Signature: 																	

One- And Six-Year Plan Highway, Road or Street Improvement Work/Project

GENERAL INFO	Name (County or Municipality): Bayard <input checked="" type="checkbox"/> Existing W/P <input type="checkbox"/> New W/P <input type="checkbox"/> Revision W/P							
	Work/Project (W/P) Number: M-137 (36c)		Work/Project Length: 300.00		feet			
	Other Work/Project Number:				Control Number:			
	Interlocal Agreement: <input type="checkbox"/> Yes <input type="checkbox"/> No If Yes, Name of Other Entity:							
REVISIONS	Location 1st Avenue from 5th Street to 6th Street. Install 1.5" bituminous overlay on existing PCC							
	Description: pavement							
STDS	If Revision, describe the changes:							
	Notification of Revision of One-Year Plan? <input type="checkbox"/> Yes <input type="checkbox"/> No If Yes, what is the reason? <input type="checkbox"/> Revisions to the Work/Project <input type="checkbox"/> Emergency Work/Proj Needed <input type="checkbox"/> Additional Funding Available <input type="checkbox"/> Other: _____							
TRAFFIC	Functional Class National: Local State: Local		Design Standards Table 2-001. 03. F National Highway System: <input type="checkbox"/> Yes <input checked="" type="checkbox"/> No					
	Design Speed: 25 MPH		Posted/Anticipated Speed = 25 MPH					
ROADWAY	Avg Daily Traffic :		Initial Year	VPD	Hvy Trucks %	Design Year	VPD	Hvy Trucks %
			2018	100	5	2050	200	5
BRIDGES & STRUCTURES	HIGHWAY, ROAD OR STREET		EXISTING		PROPOSED IMPROVEMENT			
			Surface Type	Width (ft)	Surface Type	Thickness (in)	Width (ft)	Work Type
	Traveled Way:		Concrete	38	Composite Pavement	1.5	38	MAINT
OTHER SCOPE	Shoulders:		Concrete	Curbed	Concrete	6	Curbed	
	BRIDGES AND STRUCTURES		EXISTING		PROPOSED IMPROVEMENT			
	Structure Number(s) City/County - NBIS		Structure Type	Condition SR SD FO		Structure Type	Size	Design Loading and Work Type
ANALYSES				<input type="checkbox"/>	<input type="checkbox"/>			
				<input type="checkbox"/>	<input type="checkbox"/>			
				<input type="checkbox"/>	<input type="checkbox"/>			
				<input type="checkbox"/>	<input type="checkbox"/>			
FINANCIAL	Other Scope of Work:		<input type="checkbox"/> Add Auxiliary Lane(s)	<input type="checkbox"/> Grading	<input type="checkbox"/> Acquire Right of Way	<input type="checkbox"/> Remove Existing Bridge/Structure		
			<input type="checkbox"/> Sidewalk/Trail	<input type="checkbox"/> Guardrail	<input type="checkbox"/> Other Utilities Work	<input type="checkbox"/> Bridge Re-deck		
FINANCIAL			<input type="checkbox"/> Removal of Roadside Obstacles	<input type="checkbox"/> Fencing	<input type="checkbox"/> Lighting	<input type="checkbox"/> Bridge Rail		
			<input type="checkbox"/> Flatten Vertical Curve(s)	<input type="checkbox"/> Curb Work	<input type="checkbox"/> Traffic Control Devices	<input type="checkbox"/> Storm Sewer or Culverts		
FINANCIAL			<input type="checkbox"/> Other: _____	<input type="checkbox"/> Curb Ramp(s)	<input type="checkbox"/> Construction Detour	<input type="checkbox"/> Erosion Control		
	Drainage Study Completed for Structures/Drainage Facilities		<input type="checkbox"/> Yes <input type="checkbox"/> Pending <input checked="" type="checkbox"/> N/A		Work/Project Relaxation of Standards Requested			
FINANCIAL			<input type="checkbox"/> Yes <input type="checkbox"/> Pending <input checked="" type="checkbox"/> N/A		<input type="checkbox"/> Yes <input type="checkbox"/> Pending <input checked="" type="checkbox"/> N/A			
	Analyses Completed:		Cost Effective Analysis		Other Benefit/Cost Analysis			
FINANCIAL			<input type="checkbox"/> Yes <input type="checkbox"/> Pending <input checked="" type="checkbox"/> N/A		<input type="checkbox"/> Yes <input type="checkbox"/> Pending <input checked="" type="checkbox"/> N/A			
	Nebraska licensed engineer providing design and construction phases services:							<input checked="" type="checkbox"/> Yes <input type="checkbox"/> No
FINANCIAL	Construction Period (estimated):		30.0 working days					
	Other Funds to be Applied:		<input type="checkbox"/> Federal Fund Purchase Program		<input type="checkbox"/> State-Aid Bridge Fund		<input type="checkbox"/> Federal Funds thru NDOR	
FINANCIAL			<input type="checkbox"/> LB960 County Bridge Match Program		<input type="checkbox"/> State Recreation Road Fund		<input type="checkbox"/> Other: _____	
	Estimated Costs (1,000)		County	Municipality	State	Federal	Other	Total
FINANCIAL				100			100	
	Print Name: Jeff Wolfe		Signature: <i>Jeff Wolfe</i>		Title: City Street Superintendent	Date: 11/12/2024		

One- And Six-Year Plan Highway, Road or Street Improvement Work/Project

GENERAL INFO	Name (County or Municipality): Bayard <input checked="" type="checkbox"/> Existing W/P <input type="checkbox"/> New W/P <input type="checkbox"/> Revision W/P																		
	Work/Project (W/P) Number: M-137 (48)		Work/Project Length: 0.30		miles														
	Other Work/Project Number:				Control Number:														
	Interlocal Agreement: <input type="checkbox"/> Yes <input type="checkbox"/> No If Yes, Name of Other Entity:																		
REVISIONS	Location 13th Street from Main Street to Avenue C. Install new PCC pavement, curb, gutter, and																		
	Description: walks.																		
STDS	If Revision, describe the changes:																		
	Notification of Revision of One-Year Plan? <input type="checkbox"/> Yes <input type="checkbox"/> No If Yes, what is the reason?																		
TRAFFIC	<input type="checkbox"/> Revisions to the Work/Project <input type="checkbox"/> Other: _____ <input type="checkbox"/> Emergency Work/Proj Needed _____ <input type="checkbox"/> Additional Funding Available _____																		
	Functional Class National: Local State: Local Design Standards Table 2-001. 03. F National Highway System: <input type="checkbox"/> Yes <input checked="" type="checkbox"/> No																		
ROADWAY	Design Speed: 25 MPH Posted/Anticipated Speed = 25 MPH																		
	<table border="1" style="width: 100%; border-collapse: collapse;"> <tr> <td rowspan="2">Avg Daily Traffic :</td> <td>Initial Year</td> <td>VPD</td> <td>Hvy Trucks %</td> <td>Design Year</td> <td>VPD</td> <td>Hvy Trucks %</td> </tr> <tr> <td>2018</td> <td>100</td> <td>5</td> <td>2050</td> <td>200</td> <td>5</td> </tr> </table>							Avg Daily Traffic :	Initial Year	VPD	Hvy Trucks %	Design Year	VPD	Hvy Trucks %	2018	100	5	2050	200
Avg Daily Traffic :	Initial Year	VPD	Hvy Trucks %	Design Year	VPD	Hvy Trucks %													
	2018	100	5	2050	200	5													
BRIDGES & STRUCTURES	HIGHWAY, ROAD OR STREET		EXISTING		PROPOSED IMPROVEMENT														
			Surface Type	Width (ft)	Surface Type	Thickness (in)	Width (ft)	Work Type											
Traveled Way:		Gravel	32	Concrete	6	32	N&R												
Shoulders:		Earth	4	Concrete	6	Curbed													
OTHER SCOPE	BRIDGES AND STRUCTURES		EXISTING		PROPOSED IMPROVEMENT														
	Structure Number(s) City/County - NBIS		Structure Type	Condition SR SD FO	Structure Type	Size	Design Loading and Work Type												
			____ <input type="checkbox"/> <input type="checkbox"/>																
			____ <input type="checkbox"/> <input type="checkbox"/>																
			____ <input type="checkbox"/> <input type="checkbox"/>																
			____ <input type="checkbox"/> <input type="checkbox"/>																
ANALYSES	Other Scope of Work:																		
	<input type="checkbox"/> Add Auxiliary Lane(s) <input checked="" type="checkbox"/> Grading <input type="checkbox"/> Acquire Right of Way <input type="checkbox"/> Remove Existing Bridge/Structure <input type="checkbox"/> Sidewalk/Trail <input type="checkbox"/> Guardrail <input type="checkbox"/> Other Utilities Work <input type="checkbox"/> Bridge Re-deck <input type="checkbox"/> Removal of Roadside Obstacles <input type="checkbox"/> Fencing <input type="checkbox"/> Lighting <input type="checkbox"/> Bridge Rail <input type="checkbox"/> Flatten Vertical Curve(s) <input checked="" type="checkbox"/> Curb Work <input type="checkbox"/> Traffic Control Devices <input type="checkbox"/> Storm Sewer or Culverts <input type="checkbox"/> Other: _____ <input checked="" type="checkbox"/> Curb Ramp(s) <input type="checkbox"/> Construction Detour <input type="checkbox"/> Erosion Control																		
FINANCIAL	Drainage Study Completed for Structures/Drainage Facilities <input type="checkbox"/> Yes <input type="checkbox"/> Pending <input checked="" type="checkbox"/> N/A																		
	Work/Project Relaxation of Standards Requested <input type="checkbox"/> Yes <input type="checkbox"/> Pending <input checked="" type="checkbox"/> N/A																		
Analyses Completed: <input type="checkbox"/> Yes <input type="checkbox"/> Pending <input checked="" type="checkbox"/> N/A																			
Cost Effective Analysis <input type="checkbox"/> Yes <input type="checkbox"/> Pending <input checked="" type="checkbox"/> N/A																			
Other Benefit/Cost Analysis <input type="checkbox"/> Yes <input type="checkbox"/> Pending <input checked="" type="checkbox"/> N/A																			
Nebraska licensed engineer providing design and construction phases services: <input checked="" type="checkbox"/> Yes <input type="checkbox"/> No																			
Construction Period (estimated): 90.0 working days																			
Other Funds to be Applied:																			
<input type="checkbox"/> Federal Fund Purchase Program <input type="checkbox"/> State-Aid Bridge Fund <input type="checkbox"/> Federal Funds thru NDOR <input type="checkbox"/> LB960 County Bridge Match Program <input type="checkbox"/> State Recreation Road Fund <input type="checkbox"/> Other: _____																			
<table border="1" style="width: 100%; border-collapse: collapse;"> <tr> <td rowspan="2">Estimated Costs (1,000)</td> <td>County</td> <td>Municipality</td> <td>State</td> <td>Federal</td> <td>Other</td> <td>Total</td> </tr> <tr> <td></td> <td>350</td> <td></td> <td></td> <td></td> <td>350</td> </tr> </table>							Estimated Costs (1,000)	County	Municipality	State	Federal	Other	Total		350				350
Estimated Costs (1,000)	County	Municipality	State	Federal	Other	Total													
		350				350													
Print Name: Jeff Wolfe																			
Signature: 		Title: City Street Superintendent		Date: 11/12/2024															

One- And Six-Year Plan Highway, Road or Street Improvement Work/Project

GENERAL INFO	Name (County or Municipality): Bayard <input checked="" type="checkbox"/> Existing W/P <input type="checkbox"/> New W/P <input type="checkbox"/> Revision W/P	
	Work/Project (W/P) Number: M-137 (49)	Work/Project Length: 0.30 miles
	Other Work/Project Number: _____	Control Number: _____
	Interlocal Agreement: <input type="checkbox"/> Yes <input type="checkbox"/> No If Yes, Name of Other Entity: _____	
REVISIONS	Location 14th Street from Main Street to Avenue C. Install new PCC pavement, curb, gutter, and	
	Description: walks.	
STDS	If Revision, describe the changes: _____	
	Notification of Revision of One-Year Plan? <input type="checkbox"/> Yes <input type="checkbox"/> No If Yes, what is the reason?	
TRAFFIC	<input type="checkbox"/> Revisions to the Work/Project <input type="checkbox"/> Other: _____	
	<input type="checkbox"/> Emergency Work/Proj Needed _____	
ROADWAY	<input type="checkbox"/> Additional Funding Available _____	
	Functional Class National: Local State: Local	
SPD	Design Standards Table 2-001. 03. F National Highway System: <input type="checkbox"/> Yes <input checked="" type="checkbox"/> No	
	Design Speed: 25 MPH Posted/Anticipated Speed = 25 MPH	
STRUCTURES	Avg Daily Traffic :	
	Initial Year	VPD
OTHER SCOPE	Hvy Trucks %	Design Year
	2018	2050
ANALYSES	VPD	Hvy Trucks %
	100	5
FINANCIAL	200	5
	HIGHWAY, ROAD OR STREET	
FINANCIAL	EXISTING	
	PROPOSED IMPROVEMENT	
FINANCIAL	Surface Type	Width (ft)
	Surface Type	Thickness (in)
FINANCIAL	Width (ft)	Work Type
	Traveled Way:	Gravel
FINANCIAL	Shoulders:	Earth
	Structure Number(s)	Structure
FINANCIAL	City/County - NBIS	Condition
	Structure Type	SR SD FO
FINANCIAL	Structure Type	Size
	Design Loading and Work Type	
FINANCIAL	Other Scope of Work:	
	<input type="checkbox"/> Add Auxiliary Lane(s)	<input checked="" type="checkbox"/> Grading
FINANCIAL	<input type="checkbox"/> Sidewalk/Trail	<input type="checkbox"/> Guardrail
	<input type="checkbox"/> Removal of Roadside Obstacles	<input type="checkbox"/> Fencing
FINANCIAL	<input type="checkbox"/> Flatten Vertical Curve(s)	<input checked="" type="checkbox"/> Curb Work
	<input type="checkbox"/> Other: _____	<input type="checkbox"/> Acquire Right of Way
FINANCIAL	<input type="checkbox"/> Other Utilities Work	<input type="checkbox"/> Remove Existing Bridge/Structure
	<input type="checkbox"/> Construction Detour	<input type="checkbox"/> Bridge Re-deck
FINANCIAL	<input type="checkbox"/> Lighting	<input type="checkbox"/> Bridge Rail
	<input type="checkbox"/> Traffic Control Devices	<input type="checkbox"/> Storm Sewer or Culverts
FINANCIAL	<input type="checkbox"/> Erosion Control	<input type="checkbox"/> Erosion Control
	Drainage Study Completed for Structures/Drainage Facilities	Work/Project Relaxation of Standards Requested
FINANCIAL	<input type="checkbox"/> Yes <input type="checkbox"/> Pending <input checked="" type="checkbox"/> N/A	<input type="checkbox"/> Yes <input type="checkbox"/> Pending <input checked="" type="checkbox"/> N/A
	Analyses Completed:	Cost Effective Analysis
FINANCIAL	<input type="checkbox"/> Yes <input type="checkbox"/> Pending <input checked="" type="checkbox"/> N/A	Other Benefit/Cost Analysis
	<input type="checkbox"/> Yes <input type="checkbox"/> Pending <input checked="" type="checkbox"/> N/A	
FINANCIAL	Nebraska licensed engineer providing design and construction phases services: <input checked="" type="checkbox"/> Yes <input type="checkbox"/> No	
	Construction Period (estimated): 90.0 working days	
FINANCIAL	Other Funds to be Applied:	
	<input type="checkbox"/> Federal Fund Purchase Program	<input type="checkbox"/> State-Aid Bridge Fund
FINANCIAL	<input type="checkbox"/> LB960 County Bridge Match Program	<input type="checkbox"/> State Recreation Road Fund
	<input type="checkbox"/> Other: _____	
FINANCIAL	Estimated Costs (1,000)	County
		Municipality
FINANCIAL		State
		Federal
FINANCIAL		Other
		Total
FINANCIAL		350
		350
FINANCIAL	Print Name: Jeff Wolfe	Title: City Street Superintendent
	Signature: <i>Jeff Wolfe</i>	Date: 11/12/2024

One- And Six-Year Plan Highway, Road or Street Improvement Work/Project

GENERAL INFO	Name (County or Municipality): Bayard <input checked="" type="checkbox"/> Existing W/P <input type="checkbox"/> New W/P <input type="checkbox"/> Revision W/P							
	Work/Project (W/P) Number: M-137 (50)		Work/Project Length: N/A		miles			
	Other Work/Project Number:				Control Number:			
	Interlocal Agreement: <input type="checkbox"/> Yes <input type="checkbox"/> No If Yes, Name of Other Entity:							
REVISIONS	Location							
	Description: City wide ADA access ramps							
STDS	If Revision, describe the changes:							
	Notification of Revision of One-Year Plan? <input type="checkbox"/> Yes <input type="checkbox"/> No If Yes, what is the reason? <input type="checkbox"/> Revisions to the Work/Project <input type="checkbox"/> Emergency Work/Proj Needed <input type="checkbox"/> Additional Funding Available <input type="checkbox"/> Other: _____							
TRAFFIC	Functional Class National: Local State: Local		Design Standards Table 2-001. 03. F National Highway System: <input type="checkbox"/> Yes <input checked="" type="checkbox"/> No					
	Design Speed: 25 MPH		Posted/Anticipated Speed = 25 MPH					
ROADWAY	Avg Daily Traffic :		Initial Year	VPD	Hvy Trucks %	Design Year	VPD	Hvy Trucks %
			2025	100	5	2055	200	5
BRIDGES & STRUCTURES	HIGHWAY, ROAD OR STREET		EXISTING		PROPOSED IMPROVEMENT			
			Surface Type	Width (ft)	Surface Type	Thickness (in)	Width (ft)	Work Type
	Traveled Way:		Concrete	Varies	Concrete	6	Varies	3R
Shoulders:		Concrete	Varies	Concrete	6	Curbed		
OTHER SCOPE	BRIDGES AND STRUCTURES		EXISTING		PROPOSED IMPROVEMENT			
	Structure Number(s)		Structure	Condition		Structure Type	Size	Design Loading and Work Type
	City/County - NBIS		Type	SR	SD			
				_____	<input type="checkbox"/>	<input type="checkbox"/>		
				_____	<input type="checkbox"/>	<input type="checkbox"/>		
			_____	<input type="checkbox"/>	<input type="checkbox"/>			
			_____	<input type="checkbox"/>	<input type="checkbox"/>			
ANALYSES	Other Scope of Work:				<input type="checkbox"/> Grading <input type="checkbox"/> Acquire Right of Way <input type="checkbox"/> Remove Existing Bridge/Structure <input type="checkbox"/> Add Auxiliary Lane(s) <input type="checkbox"/> Guardrail <input type="checkbox"/> Other Utilities Work <input type="checkbox"/> Bridge Re-deck <input type="checkbox"/> Sidewalk/Trail <input type="checkbox"/> Fencing <input type="checkbox"/> Lighting <input type="checkbox"/> Bridge Rail <input type="checkbox"/> Removal of Roadside Obstacles <input checked="" type="checkbox"/> Curb Work <input type="checkbox"/> Traffic Control Devices <input type="checkbox"/> Storm Sewer or Culverts <input type="checkbox"/> Flatten Vertical Curve(s) <input checked="" type="checkbox"/> Curb Ramp(s) <input type="checkbox"/> Construction Detour <input type="checkbox"/> Erosion Control <input type="checkbox"/> Other: _____			
	Drainage Study Completed for Structures/Drainage Facilities <input type="checkbox"/> Yes <input type="checkbox"/> Pending <input checked="" type="checkbox"/> N/A				Work/Project Relaxation of Standards Requested <input type="checkbox"/> Yes <input type="checkbox"/> Pending <input checked="" type="checkbox"/> N/A			
FINANCIAL	Analyses Completed: <input type="checkbox"/> Yes <input type="checkbox"/> Pending <input checked="" type="checkbox"/> N/A				Other Benefit/Cost Analysis <input type="checkbox"/> Yes <input type="checkbox"/> Pending <input checked="" type="checkbox"/> N/A			
	Cost Effective Analysis				Other Benefit/Cost Analysis			
Nebraska licensed engineer providing design and construction phases services: <input checked="" type="checkbox"/> Yes <input type="checkbox"/> No								
Construction Period (estimated): 60.0 working days								
Other Funds to be Applied: <input type="checkbox"/> Federal Fund Purchase Program <input type="checkbox"/> State-Aid Bridge Fund <input type="checkbox"/> Federal Funds thru NDOR <input type="checkbox"/> LB960 County Bridge Match Program <input type="checkbox"/> State Recreation Road Fund <input type="checkbox"/> Other: _____								
Estimated Costs (1,000)		County	Municipality	State	Federal	Other	Total	
			75				75	
Print Name: Jeff Wolfe			Title: City Street Superintendent		Date: 11/12/2024			
Signature: <i>Jeff Wolfe</i>								

One- And Six-Year Plan Highway, Road or Street Improvement Work/Project

GENERAL INFO	Name (County or Municipality): Bayard <input checked="" type="checkbox"/> Existing W/P <input type="checkbox"/> New W/P <input type="checkbox"/> Revision W/P							
	Work/Project (W/P) Number: M-137 (51)		Work/Project Length: 0.20		miles			
	Other Work/Project Number:				Control Number:			
	Interlocal Agreement: <input type="checkbox"/> Yes <input type="checkbox"/> No If Yes, Name of Other Entity:							
REVISIONS	Location							
	Description: Avenue A from 10th Street to 11th Street. Seal coat existing asphalt surface							
STDS	If Revision, describe the changes:							
	Notification of Revision of One-Year Plan? <input type="checkbox"/> Yes <input type="checkbox"/> No If Yes, what is the reason? <input type="checkbox"/> Revisions to the Work/Project <input type="checkbox"/> Emergency Work/Proj Needed <input type="checkbox"/> Additional Funding Available <input type="checkbox"/> Other: _____							
TRAFFIC	Functional Class National: Local State: Local		Design Standards Table 2-001. 03. F National Highway System: <input type="checkbox"/> Yes <input checked="" type="checkbox"/> No					
	Design Speed: 25 MPH		Posted/Anticipated Speed = 25 MPH					
ROADWAY	Avg Daily Traffic :		Initial Year	VPD	Hvy Trucks %	Design Year	VPD	Hvy Trucks %
			2025	100	5	2055	200	5
BRIDGES & STRUCTURES	HIGHWAY, ROAD OR STREET		EXISTING		PROPOSED IMPROVEMENT			
			Surface Type	Width (ft)	Surface Type	Thickness (in)	Width (ft)	Work Type
	Traveled Way:		Asphalt	32	Asphalt	0.5	32	MAINT
Shoulders:		Concrete	Curbed	Concrete	6	Curbed		
OTHER SCOPE	BRIDGES AND STRUCTURES		EXISTING		PROPOSED IMPROVEMENT			
	Structure Number(s)		Structure	Condition		Structure Type	Size	Design Loading and Work Type
	City/County - NBIS		Type	SR	SD			
				_____	<input type="checkbox"/>	<input type="checkbox"/>		
				_____	<input type="checkbox"/>	<input type="checkbox"/>		
			_____	<input type="checkbox"/>	<input type="checkbox"/>			
			_____	<input type="checkbox"/>	<input type="checkbox"/>			
ANALYSES	Other Scope of Work:				<input type="checkbox"/> Grading <input type="checkbox"/> Acquire Right of Way <input type="checkbox"/> Remove Existing Bridge/Structure <input type="checkbox"/> Add Auxiliary Lane(s) <input type="checkbox"/> Guardrail <input type="checkbox"/> Other Utilities Work <input type="checkbox"/> Bridge Re-deck <input type="checkbox"/> Sidewalk/Trail <input type="checkbox"/> Fencing <input type="checkbox"/> Lighting <input type="checkbox"/> Bridge Rail <input type="checkbox"/> Removal of Roadside Obstacles <input type="checkbox"/> Curb Work <input type="checkbox"/> Traffic Control Devices <input type="checkbox"/> Storm Sewer or Culverts <input type="checkbox"/> Flatten Vertical Curve(s) <input type="checkbox"/> Curb Ramp(s) <input type="checkbox"/> Construction Detour <input type="checkbox"/> Erosion Control <input type="checkbox"/> Other: _____			
	Drainage Study Completed for Structures/Drainage Facilities <input type="checkbox"/> Yes <input type="checkbox"/> Pending <input checked="" type="checkbox"/> N/A				Work/Project Relaxation of Standards Requested <input type="checkbox"/> Yes <input type="checkbox"/> Pending <input checked="" type="checkbox"/> N/A			
FINANCIAL	Analyses Completed: <input type="checkbox"/> Yes <input type="checkbox"/> Pending <input checked="" type="checkbox"/> N/A				Other Benefit/Cost Analysis <input type="checkbox"/> Yes <input type="checkbox"/> Pending <input checked="" type="checkbox"/> N/A			
	Nebraska licensed engineer providing design and construction phases services: <input checked="" type="checkbox"/> Yes <input type="checkbox"/> No				Construction Period (estimated): 10.0 working days			
Other Funds to be Applied:		<input type="checkbox"/> Federal Fund Purchase Program <input type="checkbox"/> State-Aid Bridge Fund <input type="checkbox"/> Federal Funds thru NDOR		<input type="checkbox"/> LB960 County Bridge Match Program <input type="checkbox"/> State Recreation Road Fund <input type="checkbox"/> Other: _____				
Estimated Costs (1,000)		County	Municipality	State	Federal	Other	Total	
			30				30	
Print Name: Jeff Wolfe		Signature: 		Title: City Street Superintendent		Date: 11/12/2024		

One- And Six-Year Plan Highway, Road or Street Improvement Work/Project

GENERAL INFO	Name (County or Municipality): Bayard <input checked="" type="checkbox"/> Existing W/P <input type="checkbox"/> New W/P <input type="checkbox"/> Revision W/P						
	Work/Project (W/P) Number: M-137 (52)		Work/Project Length: 0.10 miles				
	Other Work/Project Number:				Control Number:		
	Interlocal Agreement: <input type="checkbox"/> Yes <input type="checkbox"/> No If Yes, Name of Other Entity:						
REVISIONS	Location						
	Description: 2nd Avenue from 4th Street to 5th Street. Remove and replace pavement, curb, and gutter.						
STDS	If Revision, describe the changes:						
	Notification of Revision of One-Year Plan? <input type="checkbox"/> Yes <input type="checkbox"/> No If Yes, what is the reason? <input type="checkbox"/> Revisions to the Work/Project <input type="checkbox"/> Emergency Work/Proj Needed <input type="checkbox"/> Additional Funding Available <input type="checkbox"/> Other: _____						
TRAFFIC	Functional Class National: Local State: Local						
	Design Standards Table 2-001. 03. F		National Highway System: <input type="checkbox"/> Yes <input checked="" type="checkbox"/> No				
ROADWAY	Design Speed: 25 MPH		Posted/Anticipated Speed = 25 MPH				
	Avg Daily Traffic :	Initial Year 2025	VPD 100	Hvy Trucks % 5	Design Year 2055	VPD 200	Hvy Trucks % 5
BRIDGES & STRUCTURES	HIGHWAY, ROAD OR STREET		EXISTING		PROPOSED IMPROVEMENT		
	Traveled Way:	Concrete	34	Concrete	8	34	3R
	Shoulders:	Concrete	Curbed	Concrete	6	Curbed	
OTHER SCOPE	Structure Number(s) City/County - NBIS		Structure Type	Condition SR SD FO	Structure Type	Size	Design Loading and Work Type
				____ <input type="checkbox"/> <input type="checkbox"/>			
				____ <input type="checkbox"/> <input type="checkbox"/>			
				____ <input type="checkbox"/> <input type="checkbox"/>			
ANALYSES	Other Scope of Work:			Work/Project Relaxation of Standards Requested			
	<input type="checkbox"/> Add Auxiliary Lane(s) <input type="checkbox"/> Grading <input type="checkbox"/> Acquire Right of Way <input type="checkbox"/> Remove Existing Bridge/Structure <input type="checkbox"/> Sidewalk/Trail <input type="checkbox"/> Guardrail <input type="checkbox"/> Other Utilities Work <input type="checkbox"/> Bridge Re-deck <input type="checkbox"/> Removal of Roadside Obstacles <input type="checkbox"/> Fencing <input type="checkbox"/> Lighting <input type="checkbox"/> Bridge Rail <input type="checkbox"/> Flatten Vertical Curve(s) <input type="checkbox"/> Curb Work <input type="checkbox"/> Traffic Control Devices <input type="checkbox"/> Storm Sewer or Culverts <input type="checkbox"/> Curb Ramp(s) <input type="checkbox"/> Construction Detour <input type="checkbox"/> Erosion Control <input type="checkbox"/> Other: _____			<input type="checkbox"/> Yes <input type="checkbox"/> Pending <input checked="" type="checkbox"/> N/A			
FINANCIAL	Drainage Study Completed for Structures/Drainage Facilities			Work/Project Relaxation of Standards Requested			
	<input type="checkbox"/> Yes <input type="checkbox"/> Pending <input checked="" type="checkbox"/> N/A			<input type="checkbox"/> Yes <input type="checkbox"/> Pending <input checked="" type="checkbox"/> N/A			
FINANCIAL	Analyses Completed:			Other Benefit/Cost Analysis			
	<input type="checkbox"/> Yes <input type="checkbox"/> Pending <input checked="" type="checkbox"/> N/A			<input type="checkbox"/> Yes <input type="checkbox"/> Pending <input checked="" type="checkbox"/> N/A			
FINANCIAL	Nebraska licensed engineer providing design and construction phases services: <input checked="" type="checkbox"/> Yes <input type="checkbox"/> No						
	Construction Period (estimated): 20.0 working days						
FINANCIAL	Other Funds to be Applied:						
	<input type="checkbox"/> Federal Fund Purchase Program <input type="checkbox"/> State-Aid Bridge Fund <input type="checkbox"/> Federal Funds thru NDOR <input type="checkbox"/> LB960 County Bridge Match Program <input type="checkbox"/> State Recreation Road Fund <input type="checkbox"/> Other: _____						
FINANCIAL	Estimated Costs (1,000)	County	Municipality	State	Federal	Other	Total
			350				350
FINANCIAL	Print Name: Jeff Wolfe			Title: City Street Superintendent		Date: 11/12/2024	
	Signature: <i>Jeff Wolfe</i>						

One- And Six-Year Plan Highway, Road or Street Improvement Work/Project

GENERAL INFO	Name (County or Municipality): Bayard <input type="checkbox"/> Existing W/P <input checked="" type="checkbox"/> New W/P <input type="checkbox"/> Revision W/P						
	Work/Project (W/P) Number: M-137 (53)		Work/Project Length: 0.10 miles				
	Other Work/Project Number:				Control Number:		
	Interlocal Agreement: <input type="checkbox"/> Yes <input type="checkbox"/> No If Yes, Name of Other Entity:						
REVISIONS	Location						
	Description: Reconsturct 8th Street, new curb, gutter and pavement - Main Street to 1st Avenue						
STNDS	If Revision, describe the changes:						
	Notification of Revision of One-Year Plan? <input type="checkbox"/> Yes <input type="checkbox"/> No If Yes, what is the reason? <input type="checkbox"/> Revisions to the Work/Project <input type="checkbox"/> Emergency Work/Proj Needed <input type="checkbox"/> Additional Funding Available <input type="checkbox"/> Other: _____						
TRAFF SPD	Functional Class <i>National:</i> Major Collector		State: Other Arterial				
	Design Standards Table 2-001. 03. F		National Highway System: <input type="checkbox"/> Yes <input checked="" type="checkbox"/> No				
ROADWAY	Design Speed: 25 MPH		Posted/Anticipated Speed = 25 MPH				
	Avg Daily Traffic :	Initial Year 2025	VPD 200	Hvy Trucks % 10	Design Year 2055	VPD 300	Hvy Trucks % 12
BRIDGES & STRUCTURES	HIGHWAY, ROAD OR STREET		EXISTING		PROPOSED IMPROVEMENT		
	Traveled Way:	Concrete	39	Concrete	6	39	3R
	Shoulders:	Concrete	Curbed	Concrete	6	Curbed	
OTHER SCOPE	Structure Number(s) City/County - NBIS		Structure Type	Condition SR SD FO	Structure Type	Size	Design Loading and Work Type
				____ <input type="checkbox"/> <input type="checkbox"/>			
				____ <input type="checkbox"/> <input type="checkbox"/>			
				____ <input type="checkbox"/> <input type="checkbox"/>			
				____ <input type="checkbox"/> <input type="checkbox"/>			
ANALYSES	Other Scope of Work:			Work/Project Relaxation of Standards Requested			
	<input type="checkbox"/> Add Auxiliary Lane(s) <input type="checkbox"/> Grading <input type="checkbox"/> Acquire Right of Way <input type="checkbox"/> Remove Existing Bridge/Structure <input type="checkbox"/> Sidewalk/Trail <input type="checkbox"/> Guardrail <input type="checkbox"/> Other Utilities Work <input type="checkbox"/> Bridge Re-deck <input type="checkbox"/> Removal of Roadside Obstacles <input type="checkbox"/> Fencing <input type="checkbox"/> Lighting <input type="checkbox"/> Bridge Rail <input type="checkbox"/> Flatten Vertical Curve(s) <input checked="" type="checkbox"/> Curb Work <input type="checkbox"/> Traffic Control Devices <input type="checkbox"/> Storm Sewer or Culverts <input type="checkbox"/> Curb Ramp(s) <input type="checkbox"/> Construction Detour <input type="checkbox"/> Erosion Control <input type="checkbox"/> Other: _____			<input type="checkbox"/> Yes <input type="checkbox"/> Pending <input checked="" type="checkbox"/> N/A			
FINANCIAL	Drainage Study Completed for Structures/Drainage Facilities			Cost Effective Analysis			
	<input type="checkbox"/> Yes <input type="checkbox"/> Pending <input checked="" type="checkbox"/> N/A			<input type="checkbox"/> Yes <input type="checkbox"/> Pending <input checked="" type="checkbox"/> N/A			
FINANCIAL	Analyses Completed: <input type="checkbox"/> Yes <input type="checkbox"/> Pending <input checked="" type="checkbox"/> N/A						
	Other Benefit/Cost Analysis Completed: <input type="checkbox"/> Yes <input type="checkbox"/> Pending <input checked="" type="checkbox"/> N/A						
	Nebraska licensed engineer providing design and construction phases services: <input checked="" type="checkbox"/> Yes <input type="checkbox"/> No						
Construction Period (estimated): 40.0 working days							
FINANCIAL	Other Funds to be Applied:		Federal Fund Purchase Program <input type="checkbox"/> State-Aid Bridge Fund <input type="checkbox"/>		Federal Funds thru NDOR <input type="checkbox"/>		
	LB960 County Bridge Match Program <input type="checkbox"/> State Recreation Road Fund <input type="checkbox"/>		Other: _____				
FINANCIAL	Estimated Costs (1,000)	County	Municipality	State	Federal	Other	Total
			350				350
FINANCIAL	Print Name: Jeff Wolfe		Title: City Street Superintendent		Date: 11/12/2024		
	Signature: <i>Jeff Wolfe</i>						

One- And Six-Year Plan Highway, Road or Street Improvement Work/Project

GENERAL INFO	Name (County or Municipality): Bayard <input type="checkbox"/> Existing W/P <input checked="" type="checkbox"/> New W/P <input type="checkbox"/> Revision W/P							
	Work/Project (W/P) Number: M-137 (54)		Work/Project Length: 0.10 miles					
	Other Work/Project Number:				Control Number:			
	Interlocal Agreement: <input type="checkbox"/> Yes <input type="checkbox"/> No If Yes, Name of Other Entity:							
STDS	Location							
	Description: Reconsturct Intersection - 6th Street & 1st Avenue							
REVISIONS	If Revision, describe the changes:							
	Notification of Revision of One-Year Plan? <input type="checkbox"/> Yes <input type="checkbox"/> No		If Yes, what is the reason?		<input type="checkbox"/> Revisions to the Work/Project <input type="checkbox"/> Emergency Work/Proj Needed <input type="checkbox"/> Additional Funding Available <input type="checkbox"/> Other: _____			
TRAFFIC	Functional Class National: Local State: Local							
	Design Standards Table 2-001. 03. F		National Highway System: <input type="checkbox"/> Yes <input checked="" type="checkbox"/> No					
ROADWAY	Design Speed: 25 MPH		Posted/Anticipated Speed = 25 MPH					
	Avg Daily Traffic :	Initial Year	VPD	Hvy Trucks %	Design Year	VPD	Hvy Trucks %	
BRIDGES & STRUCTURES	2025		100	5	2055	200	5	
	HIGHWAY, ROAD OR STREET	EXISTING		PROPOSED IMPROVEMENT				
		Surface Type	Width (ft)	Surface Type	Thickness (in)	Width (ft)	Work Type	
	Traveled Way:	Concrete	30	Concrete	6	30	3R	
Shoulders:	Concrete	Curbed	Concrete	6	Curbed			
OTHER SCOPE	BRIDGES AND STRUCTURES		EXISTING		PROPOSED IMPROVEMENT			
	Structure Number(s)		Structure	Condition		Structure Type	Size	Design Loading and Work Type
	City/County - NBIS		Type	SR	SD			
				_____	<input type="checkbox"/>	<input type="checkbox"/>		
			_____	<input type="checkbox"/>	<input type="checkbox"/>			
			_____	<input type="checkbox"/>	<input type="checkbox"/>			
			_____	<input type="checkbox"/>	<input type="checkbox"/>			
ANALYSES	Other Scope of Work:			<input type="checkbox"/> Grading <input type="checkbox"/> Acquire Right of Way <input type="checkbox"/> Remove Existing Bridge/Structure <input type="checkbox"/> Add Auxiliary Lane(s) <input type="checkbox"/> Guardrail <input type="checkbox"/> Other Utilities Work <input type="checkbox"/> Bridge Re-deck <input type="checkbox"/> Sidewalk/Trail <input type="checkbox"/> Fencing <input type="checkbox"/> Lighting <input type="checkbox"/> Bridge Rail <input type="checkbox"/> Removal of Roadside Obstacles <input checked="" type="checkbox"/> Curb Work <input type="checkbox"/> Traffic Control Devices <input type="checkbox"/> Storm Sewer or Culverts <input type="checkbox"/> Flatten Vertical Curve(s) <input type="checkbox"/> Curb Ramp(s) <input type="checkbox"/> Construction Detour <input type="checkbox"/> Erosion Control <input type="checkbox"/> Other: _____				
	Drainage Study Completed for Structures/Drainage Facilities <input type="checkbox"/> Yes <input type="checkbox"/> Pending <input checked="" type="checkbox"/> N/A			Work/Project Relaxation of Standards Requested <input type="checkbox"/> Yes <input type="checkbox"/> Pending <input checked="" type="checkbox"/> N/A				
FINANCIAL	Analyses Completed:			Cost Effective Analysis <input type="checkbox"/> Yes <input type="checkbox"/> Pending <input checked="" type="checkbox"/> N/A Other Benefit/Cost Analysis <input type="checkbox"/> Yes <input type="checkbox"/> Pending <input checked="" type="checkbox"/> N/A				
	Nebraska licensed engineer providing design and construction phases services: <input checked="" type="checkbox"/> Yes <input type="checkbox"/> No							
Construction Period (estimated): 40.0 working days								
FINANCIAL	Other Funds to be Applied:		<input type="checkbox"/> Federal Fund Purchase Program <input type="checkbox"/> State-Aid Bridge Fund <input type="checkbox"/> LB960 County Bridge Match Program <input type="checkbox"/> State Recreation Road Fund		<input type="checkbox"/> Federal Funds thru NDOR <input type="checkbox"/> Other: _____			
	Estimated Costs (1,000)	County	Municipality	State	Federal	Other	Total	
		300					300	
Print Name: Jeff Wolfe			Title: City Street Superintendent		Date: 11/12/2024			
Signature: <i>Jeff Wolfe</i>								

One- And Six-Year Plan Highway, Road or Street Improvement Work/Project

GENERAL INFO	Name (County or Municipality): Bayard <input type="checkbox"/> Existing W/P <input checked="" type="checkbox"/> New W/P <input type="checkbox"/> Revision W/P						
	Work/Project (W/P) Number: M-137 (55)		Work/Project Length: 0.10 miles				
	Other Work/Project Number:				Control Number:		
	Interlocal Agreement: <input type="checkbox"/> Yes <input type="checkbox"/> No If Yes, Name of Other Entity:						
REVISIONS	Location						
	Description: Reconsturct 5th Street, new curb, gutter, pavement - Avenue A to Avenue B						
STNDS	If Revision, describe the changes:						
	Notification of Revision of One-Year Plan? <input type="checkbox"/> Yes <input type="checkbox"/> No If Yes, what is the reason? <input type="checkbox"/> Revisions to the Work/Project <input type="checkbox"/> Emergency Work/Proj Needed <input type="checkbox"/> Additional Funding Available <input type="checkbox"/> Other: _____						
TRAFFIC SPD	Functional Class National: Local State: Local						
	Design Standards Table 2-001. 03. F National Highway System: <input type="checkbox"/> Yes <input checked="" type="checkbox"/> No						
ROADWAY	Design Speed: 25 MPH		Posted/Anticipated Speed = 25 MPH				
	Avg Daily Traffic :	Initial Year 2025	VPD 100	Hvy Trucks % 5	Design Year 2055	VPD 200	Hvy Trucks % 5
BRIDGES & STRUCTURES	HIGHWAY, ROAD OR STREET		EXISTING		PROPOSED IMPROVEMENT		
		Surface Type	Width (ft)	Surface Type	Thickness (in)	Width (ft)	Work Type
	Traveled Way:	Concrete	29	Concrete	6	29	3R
	Shoulders:	Concrete	Curbed	Concrete	6	Curbed	
OTHER SCOPE	BRIDGES AND STRUCTURES		EXISTING		PROPOSED IMPROVEMENT		
	Structure Number(s) City/County - NBIS		Structure Type	Condition SR SD FO	Structure Type	Size	Design Loading and Work Type
				____ <input type="checkbox"/> <input type="checkbox"/>			
				____ <input type="checkbox"/> <input type="checkbox"/>			
				____ <input type="checkbox"/> <input type="checkbox"/>			
ANALYSES	Other Scope of Work:				<input type="checkbox"/> Grading <input type="checkbox"/> Acquire Right of Way <input type="checkbox"/> Remove Existing Bridge/Structure <input type="checkbox"/> Add Auxiliary Lane(s) <input type="checkbox"/> Guardrail <input type="checkbox"/> Other Utilities Work <input type="checkbox"/> Bridge Re-deck <input type="checkbox"/> Sidewalk/Trail <input type="checkbox"/> Fencing <input type="checkbox"/> Lighting <input type="checkbox"/> Bridge Rail <input type="checkbox"/> Removal of Roadside Obstacles <input checked="" type="checkbox"/> Curb Work <input type="checkbox"/> Traffic Control Devices <input type="checkbox"/> Storm Sewer or Culverts <input type="checkbox"/> Flatten Vertical Curve(s) <input type="checkbox"/> Curb Ramp(s) <input type="checkbox"/> Construction Detour <input type="checkbox"/> Erosion Control <input type="checkbox"/> Other: _____		
	Drainage Study Completed for Structures/Drainage Facilities <input type="checkbox"/> Yes <input type="checkbox"/> Pending <input checked="" type="checkbox"/> N/A				Work/Project Relaxation of Standards Requested <input type="checkbox"/> Yes <input type="checkbox"/> Pending <input checked="" type="checkbox"/> N/A		
	Analyses Completed: <input type="checkbox"/> Yes <input type="checkbox"/> Pending <input checked="" type="checkbox"/> N/A				Cost Effective Analysis <input type="checkbox"/> Yes <input type="checkbox"/> Pending <input checked="" type="checkbox"/> N/A		
					Other Benefit/Cost Analysis <input type="checkbox"/> Yes <input type="checkbox"/> Pending <input checked="" type="checkbox"/> N/A		
FINANCIAL	Nebraska licensed engineer providing design and construction phases services: <input checked="" type="checkbox"/> Yes <input type="checkbox"/> No						
	Construction Period (estimated): 40.0 working days						
	Other Funds to be Applied: <input type="checkbox"/> Federal Fund Purchase Program <input type="checkbox"/> State-Aid Bridge Fund <input type="checkbox"/> Federal Funds thru NDOR <input type="checkbox"/> LB960 County Bridge Match Program <input type="checkbox"/> State Recreation Road Fund <input type="checkbox"/> Other: _____						
	Estimated Costs (1,000)	County	Municipality	State	Federal	Other	Total
		350				350	
	Print Name: Jeff Wolfe		Title: City Street Superintendent		Date: 11/12/2024		
	Signature: <i>Jeff Wolfe</i>						

One- And Six-Year Plan Highway, Road or Street Improvement Work/Project

GENERAL INFO	Name (County or Municipality): Bayard <input type="checkbox"/> Existing W/P <input checked="" type="checkbox"/> New W/P <input type="checkbox"/> Revision W/P							
	Work/Project (W/P) Number: M-137 (56)		Work/Project Length: 0.10 miles					
	Other Work/Project Number:				Control Number:			
	Interlocal Agreement: <input type="checkbox"/> Yes <input type="checkbox"/> No If Yes, Name of Other Entity:							
STDS	Location							
	Description: Reconstruct Avenue B, new curb, gutter, pavement - 5th Street to 6th Street							
REVISIONS	If Revision, describe the changes:							
	Notification of Revision of One-Year Plan? <input type="checkbox"/> Yes <input type="checkbox"/> No		If Yes, what is the reason?		<input type="checkbox"/> Revisions to the Work/Project <input type="checkbox"/> Emergency Work/Proj Needed <input type="checkbox"/> Additional Funding Available <input type="checkbox"/> Other: _____			
TRAFFIC	Functional Class National: Local		State: Local					
	Design Standards Table 2-001. 03. F		National Highway System: <input type="checkbox"/> Yes <input checked="" type="checkbox"/> No					
ROADWAY	Design Speed: 25 MPH		Posted/Anticipated Speed = 25 MPH					
	Avg Daily Traffic :	Initial Year 2025	VPD 100	Hvy Trucks % 5	Design Year 2055	VPD 200	Hvy Trucks % 5	
BRIDGES & STRUCTURES	HIGHWAY, ROAD OR STREET		EXISTING		PROPOSED IMPROVEMENT			
		Surface Type	Width (ft)	Surface Type	Thickness (in)	Width (ft)	Work Type	
	Traveled Way:	Concrete	29	Concrete	6	29	3R	
	Shoulders:	Concrete	Curbed	Concrete	6	Curbed		
OTHER SCOPE	BRIDGES AND STRUCTURES		EXISTING		PROPOSED IMPROVEMENT			
	Structure Number(s) City/County - NBIS		Structure Type	Condition SR SD FO	Structure Type	Size	Design Loading and Work Type	
				____ <input type="checkbox"/> <input type="checkbox"/>				
				____ <input type="checkbox"/> <input type="checkbox"/>				
				____ <input type="checkbox"/> <input type="checkbox"/>				
ANALYSES	Other Scope of Work:		<input type="checkbox"/> Grading		<input type="checkbox"/> Acquire Right of Way		<input type="checkbox"/> Remove Existing Bridge/Structure	
	<input type="checkbox"/> Add Auxiliary Lane(s)		<input type="checkbox"/> Guardrail		<input type="checkbox"/> Other Utilities Work		<input type="checkbox"/> Bridge Re-deck	
	<input type="checkbox"/> Sidewalk/Trail		<input type="checkbox"/> Fencing		<input type="checkbox"/> Lighting		<input type="checkbox"/> Bridge Rail	
	<input type="checkbox"/> Removal of Roadside Obstacles		<input checked="" type="checkbox"/> Curb Work		<input type="checkbox"/> Traffic Control Devices		<input type="checkbox"/> Storm Sewer or Culverts	
<input type="checkbox"/> Flatten Vertical Curve(s)		<input type="checkbox"/> Curb Ramp(s)		<input type="checkbox"/> Construction Detour		<input type="checkbox"/> Erosion Control		
<input type="checkbox"/> Other: _____								
FINANCIAL	Drainage Study Completed for Structures/Drainage Facilities <input type="checkbox"/> Yes <input type="checkbox"/> Pending <input checked="" type="checkbox"/> N/A				Work/Project Relaxation of Standards Requested <input type="checkbox"/> Yes <input type="checkbox"/> Pending <input checked="" type="checkbox"/> N/A			
	Analyses Completed: <input type="checkbox"/> Yes <input type="checkbox"/> Pending <input checked="" type="checkbox"/> N/A				Other Benefit/Cost Analysis <input type="checkbox"/> Yes <input type="checkbox"/> Pending <input checked="" type="checkbox"/> N/A			
	Cost Effective Analysis				Other Benefit/Cost Analysis			
Nebraska licensed engineer providing design and construction phases services: <input checked="" type="checkbox"/> Yes <input type="checkbox"/> No								
Construction Period (estimated): 40.0 working days								
Other Funds to be Applied:		<input type="checkbox"/> Federal Fund Purchase Program		<input type="checkbox"/> State-Aid Bridge Fund		<input type="checkbox"/> Federal Funds thru NDOR		
		<input type="checkbox"/> LB960 County Bridge Match Program		<input type="checkbox"/> State Recreation Road Fund		<input type="checkbox"/> Other: _____		
Estimated Costs (1,000)	County	Municipality	State	Federal	Other	Total		
		350				350		
Print Name: Jeff Wolfe		Signature: 		Title: City Street Superintendent		Date: 11/12/2024		

2025 BAYARD 1-6 YR STREET PROGRAM

- 1YR PROJECTS
- 6YR PROJECTS

BAYARD
 MORRILL COUNTY
 NEBRASKA
 POPULATION 1,209 (2010 CENSUS)
 2014

R 52 W

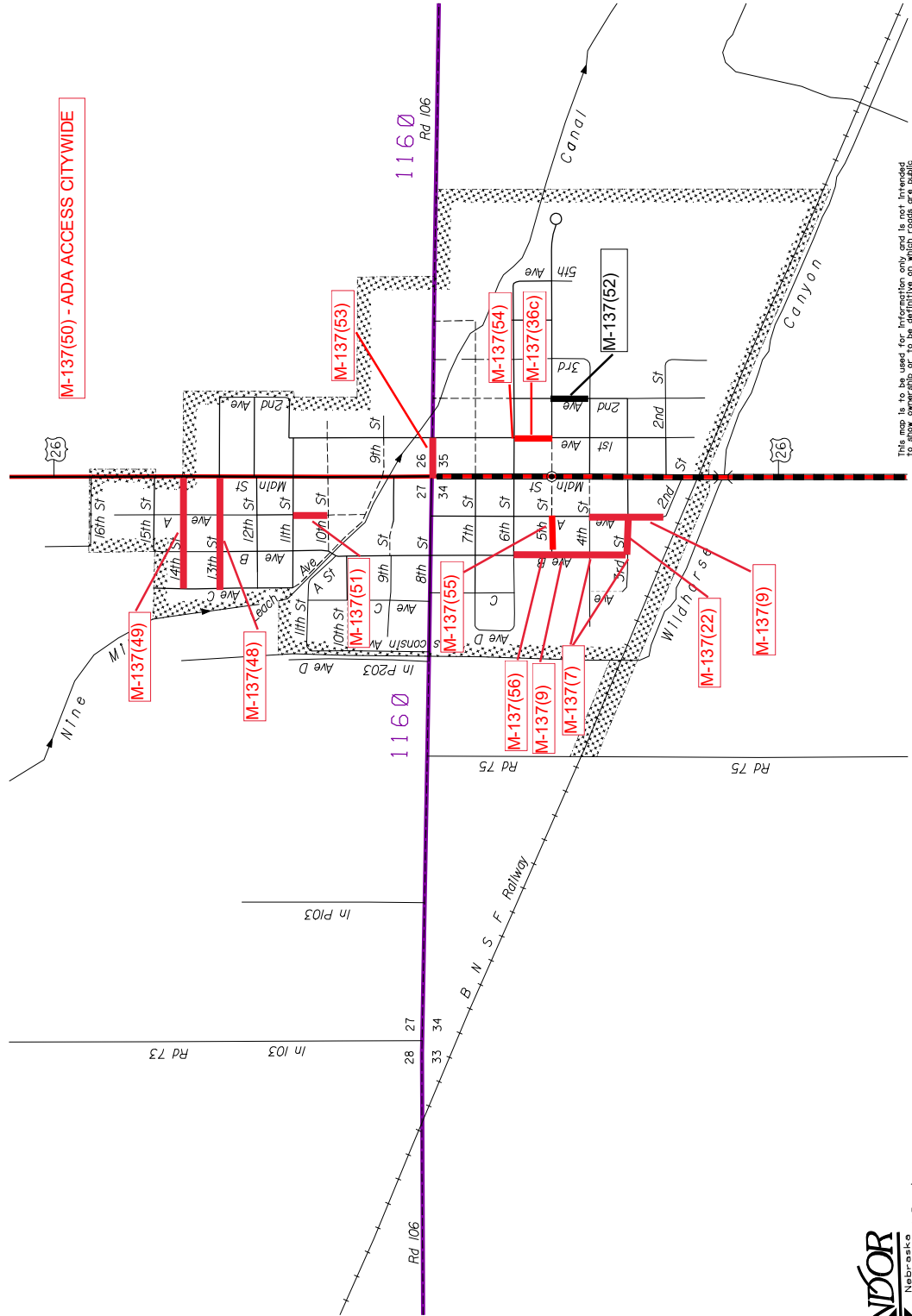

LEGEND

NATIONAL FUNCTIONAL CLASSIFICATION

- INTERSTATE
- OTHER FREeways & EXPRESSWAYS
- STATE ARTERIALS
- MAJOR ARTERIALS
- MAJOR COLLECTOR
- MINOR COLLECTOR
- URBANIZED BOUNDARY

All Roads Not Otherwise Indicated Are Classified As Local.

STATE HIGHWAYS

- Gravel or Crushed Rock
- Asphalt/Bituminous Surface
- Multiple Lane Undivided Highway
- Asphalt/Bituminous Surface
- Concrete/Brick Surface
- Multiple Lane Undivided Highway
- Concrete/Brick Surface

CITY STREETS AND COUNTY ROADS

- Primitive or Unimproved
- Gravel or Crushed Rock
- Asphalt/Bituminous Surface
- Concrete/Brick Surface
- Interstate Numbered Routes
- U.S. Numbered Routes
- State Numbered Routes
- State Numbered Spurs
- State Numbered Links
- Main St Street/Road Names
- City Center
- Corporate Limits

This map is to be used for information only and is not intended to constitute a contract. The Nebraska Department of Roads makes no warranties, guarantees or representations for the accuracy of any information or measurements shown on this map. Any inconsistencies should be reported to NIDOR.



2025 BAYARD 1-6 YR STREET PROGRAM

- 1YR PROJECTS
- 6YR PROJECTS

R 52 W

BAYARD
MORRILL COUNTY
NEBRASKA

POPULATION 1,209 (2010 CENSUS)
2014

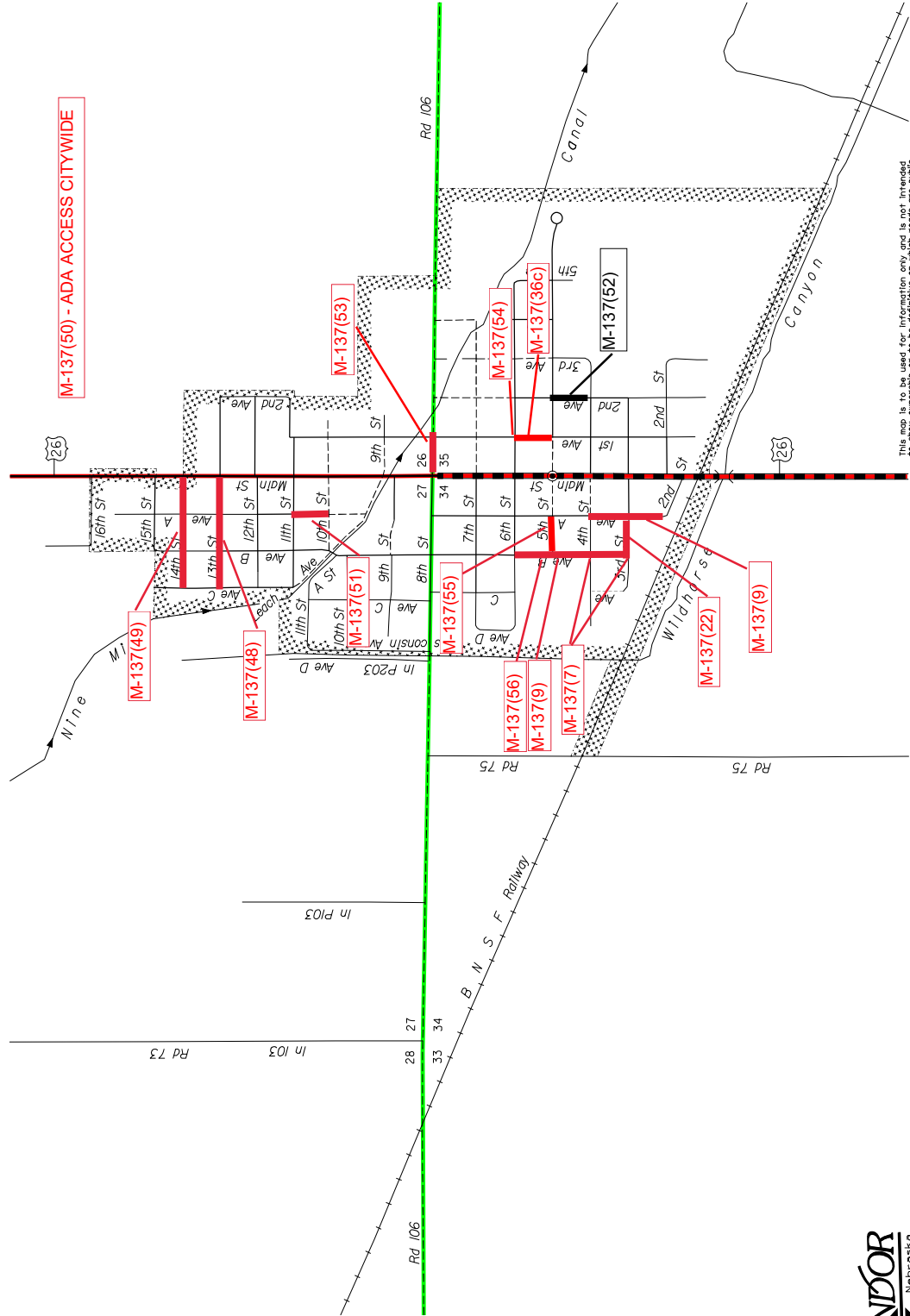

This map is to be used for information only and is not intended to show ownership or to be definitive on which roads are public or private. The engineer has no responsibility for the accuracy of the work unless, guarantee or representation for the accuracy of the work is made. Any inaccuracies should be reported to NDOB.

LEGEND

STATE FUNCTIONAL CLASSIFICATION

- INTERSTATE
- EXPRESSWAY
- MAJOR ARTERIAL
- OTHER ARTERIAL
- COLLECTOR
- REMOTE RESIDENTIAL (Rural Only)
- MINIMUM MAINTENANCE (Rural Only)
- SCenic RECREATION (Rural Only)
- UNORGANIZED BOUNDARY

STATE HIGHWAYS

- Gravel or Crushed Rock
- Asphalt/Bituminous Surface
- Multiple Lane Undivided Highway
- Asphalt/Bituminous Surface
- Concrete/Brick Surface
- Multiple Lane Undivided Highway
- Concrete/Brick Surface

CITY STREETS AND COUNTY ROADS

- Primitive or Unimproved
- Gravel or Crushed Rock
- Asphalt/Bituminous Surface
- Concrete/Brick Surface
- Interstate Numbered Routes
- U.S. Numbered Routes
- State Numbered Routes
- State Numbered Spurs
- State Numbered Links
- Main St
- Street/Road Names
- City Center
- Corporate Limits

